

State of Wyoming Corner Record

(In compliance with the *CORNER PERPETUATION AND FILING ACT*, Wyoming Statutes, 1977, Section 36-11-101, et. seq., and the Rules and Regulations of the Board of Registration for Professional Engineers and Professional Land Surveyors)

Reverse side of this form may be used if more space is needed.

Record of original survey and citation of source of historical information (if corner is lost or obliterated). Description of corner monumentation evidence found and/or monument and accessories established to perpetuate the location of this corner. Sketch of relative location of monument, accessories, and reference points with course and distance to adjacent corner(s) (if determined in this survey). Method and rationale for reestablishment of lost or obliterated corner.

1/4 Corner of Sections 9 and 10, T.12N., R.63W., 6th P.M., Laramie County, Wyoming.

G.L.O. RECORD: 1" dia. X 36" long iron pipe with 2" brass cap: Edwin H. VanAntwerp, 1911.

OTHER RECORDS: none.

FOUND: G.L.O. record monument as described above. Monument is situate in a north-south fenceline, approximately 1.0 feet northerly of a 4" dia iron pipe fence post set in a concrete base. Monument stands approximately 8" above ground level. Monument appeared as undisturbed and in good condition.

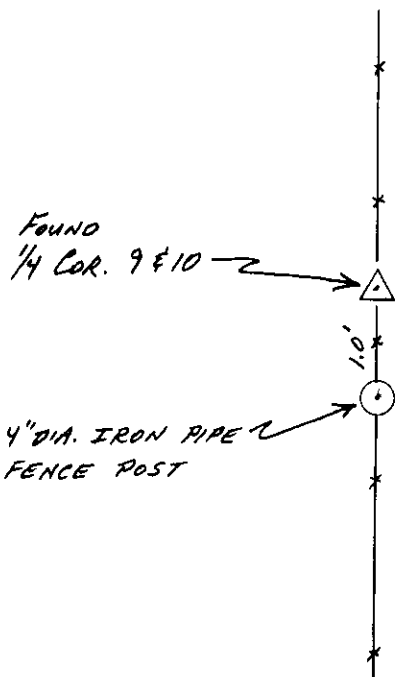

TIES TO:

SC $\frac{4}{3}{9}{10}$ N 0° 26' 44" E, 2636.30'

SC $\frac{9}{10}{16}{15}$ S 0° 24' 38" W, 2641.31'

197 MAR 31 PM 1 10

LARAMIE COUNTY CLERK
COURT HOUSE
CHEYENNE, WYO.

200176

NORTH
NOT TO SCALE

CROSS INDEX DIAGRAM

1	2	3	4	5	6	7	8	9	10	11	12	13	14	15	16	17	18	19	20	21	22	23	24	25	
A																									
B																									
C	6				5				4					3					2					1	
D																									
E																									
F																									
G	7				8				9					10					11					12	
H																									
I																									
J																									
K																									
L	18				17				16					15					14					13	
M																									
N																									
O																									
P	19				20				21					22					23					24	
Q																									
R																									
S																									
T	30				29				28					27					26					25	
U																									
V																									
W																									
X	31				32				33					34					35					36	
Y																									
Z																									

Date of Field Work: March 1997
Office Reference: _____

Firm/Agency, Address
John J. Studley, WY P.L.S. No. 4828
3509 Frontier Street
Cheyenne, Wyoming 82001
Telephone Number: (307) 634-3358

This corner record was prepared by me or under my direction

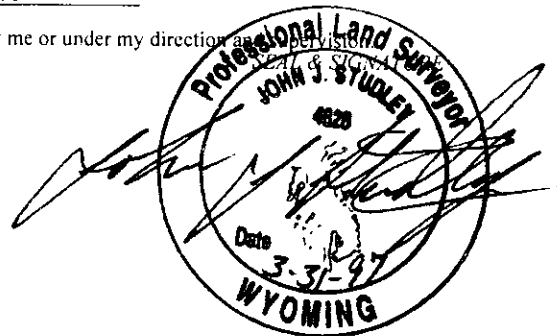

Corner Name: 1/4 Corner Sections: 9 & 10 T. 12 N, R. 63 W; 6th P.M.
Cross-Index No. G-13
SBRPEPLS/PL.SW: March 1994